

Working Opportunities in Ireland

March 2021



EasyCity



Key Talking Points

What's on the agenda

- Current situation in Ireland
- Travelling to Ireland
- Information about what to do on entering Ireland from abroad
- Working in Ireland
- Market situation
- NEW trends and opportunities
- Current work opportunities
- Q&A



EasyCity



EazyCity



Hi!

**COSTANZA LOPEZ,
HEAD OF INTERNATIONAL PROGRAMS
AT EAZYCITY**

✓ costanza@eazycity.com

☎ +353 87 165 0835



COUNTRY UNDER LEVEL 5 RESTRICTIONS

There is a Government Advisory in operation against all non-essential international travel



EXTRA SHORT-TERM MEASURES ON INTERNATIONAL TRAVEL.

- Visa-free travel to Ireland for nationals of South Africa and all countries in South America has been suspended
- Temporarily ceased accepting new visa/preclearance applications globally (with limited exemptions)

NATIONAL FRAMEWORK FOR LIVING WITH COVID-19

The plan sets out 5 levels that correspond to the severity of COVID-19 in a location. Different levels can be in place in different locations in the country.

Every county in Ireland is at Level 5 until 5 April 2021.

Current Situation in Ireland



EasyCity

National Framework for living with COVID-19

More detailed
information is
available at
gov.ie/COVID19



		Very low rate of COVID-19 infections Low R-Number			Very high rate of COVID-19 infections High R-Number		
		Level 1	Level 2	Level 3	Level 4	Level 5	
	Social & Family Gatherings	Max: 10 from 3 other households	Max: 6 from 3 other households	Max: 6 from 1 other household	No visitors	No visitors	
	Weddings	Max: 100	Max: 50	Max: 25	Max: 6	Max: 6	
	Indoor Events	Depending on venue size 100 200	Depending on venue size 50 100	No organised events	No organised events	No organised events	
	Outdoor Events	Depending on venue size 200 500	Depending on venue size 100 200	Gatherings of up to 15	Gatherings of up to 15		
	Sports Training	Normal training with protective measures	Indoors Pods of 6	1 Individual only	1 Individual only	Individual training only	
			Outdoors Pods of 15	Pods of 15 Non-contact	Pods of 15 Non-contact		
	Matches & Events	100 indoor 200 outdoor 500 stadia	50 indoor 100 outdoor 200 stadia	Except specific exemptions	Except specific exemptions	No events	
	Gyms, Pools & Leisure Centres	Open with protective measures	Open with protective measures	Individual training only	Closed	Closed	
	Religious Services	50 (or sub-groups of 50)	50 (or sub-groups of 50)	Services move online Funerals 25	Services move online Funerals 25	Services move online Funerals 10	
	Bars serving food, Cafés & Restaurants	Open with protective measures	Open Groups of 6 from up to 3 households	Range of restrictions up to and including no indoor dining	Outdoor dining only Max: 15 Takeaway/Delivery	Takeaway/Delivery only	
	Wet Pubs	Open with protective measures	Open Groups of 6 from up to 3 households	Range of restrictions up to and including no indoor service*	Outdoor only Max: 15 persons Takeaway/Delivery	Takeaway/Delivery only	
	Hotels, Guesthouses B&Bs	Open with protective measures	Open with protective measures	Services limited to Residents only	Existing Guests & Essential Purposes only	Essential Purposes only	
	Retail & Services	Mandatory face coverings Open with protective measures	Open with protective measures	Open with protective measures	Primarily outdoor Essential retail/services	Essential Retail only	
	Indoor Cultural Venues	Open with protective measures	Open with protective measures	Venues closed Libraries available for e-services/call & collect	Venues closed Online services available	Venues closed Online services available	
	Workplace	Work from home if possible Staggered attendance	Essential Meetings, Induction & Training only	Attend only if absolutely necessary	Essential & other designated workers only	Essential workers only	
	Domestic Travel	No restrictions	No restrictions	Stay in your county except for work, education & essential purposes	Stay in your county except for essential work, education & essential purposes	Stay at home Exercise within 5km	
	Public Transport	Cycle or walk if possible Mandatory face coverings	50% Capacity Peak hours prioritised to essential workers & purposes	50% Capacity Only when necessary	25% Capacity Avoid public transport	25% Capacity Avoid public transport	
	Schools & Childcare	Open with protective measures	Open with protective measures	Open with protective measures	Open with protective measures	Recommendations based on situation and evidence at time	
	Adult & Higher Education	Open with protective measures	Open with protective measures	Open Escalate all appropriate protective measures / limit congregation	Move online On-site attendance only when essential	Recommendations based on situation and evidence at time	
	Care Homes	Open with protective measures	Open with enhanced protective measures	Visiting suspended, aside from critical and compassionate circumstances			
	Over 70s & Medically Vulnerable	Exercise judgement regarding engaging with others and in activities outside home.					

*Pubs currently remain closed in Dublin

National Framework Risk Level 5



These are the restrictions for Level 5:

Social & Family Gatherings home or garden No visitors to home or garden <small>SEE NOTE 1 & 2 BELOW</small>	Indoor Sports Training None 	Religious Services Services online only 	Wet Pubs Takeaway & delivery only <small>*Remains closed to tables</small>	Workplace Work from home except essential 	Swimming Pools, Leisure Centres, Gyms Closed
Weddings Max 25 With protective measures	Outdoor Sports Training Individual only <small>SEE NOTE 3 BELOW</small> 	Funerals Up to 25 With protective measures	Retail & Personal Services Essential retail only 	Travel – Out Stay at home Exercise within 5km 	Indoor Cultural Venues Closed
Organised Indoor Events (e.g. business/training/conferences/arts events) None 	Matches & Events None <small>SEE NOTE 4 BELOW</small> 	Bars, Cafes, Restaurants serving food Takeaway & delivery only 	Schools, Early Learning, & Childcare Services Open with protective measures	Travel – In Stay at home Exercise within 5km 	Local Amenities Library services online only Playgrounds and parks open
Organised Outdoor Events None 	Long-term Residential Care Facilities Closed to visits except for critical or compassionate reasons	Hotels, Guesthouses B&Bs Essential stay only 	Adult/Higher Education Primarily online with exemptions for essential onsite activities	Public Transport Essential public transport only, walk or cycle. 	Over 70s & Medically Vulnerable Exercise judgement Stay at home as much as possible Limit social contacts

NOTES

1. You may meet up outdoors with members of one other household but not at home.
2. An extended household or support bubble will be allowed in certain cases including for those at risk of social isolation.
3. Non-contact training for school aged children can continue in outdoor pods of 15.
4. Professional elite sports, intercounty matches, horse racing and greyhound racing may continue behind closed doors.

More information on gov.ie/covid19



Rialtas na hÉireann
Government of Ireland

Entering Ireland from abroad



COMPLETE A COVID-19 PASSENGER LOCATOR FORM

- you must fill in a form before you arrive in Ireland called the COVID-19 Passenger Locator Form.
- Failure to do so is an offence.

NEGATIVE TEST

- Required to have a negative / 'not detected' result from a pre-departure COVID-19 RT-PCR test.
- Before boarding their airplane or ferry.

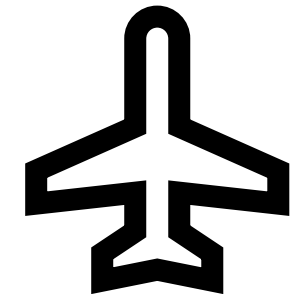
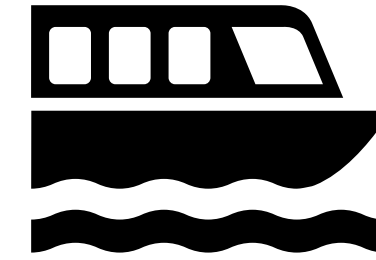

If you have queries regarding travel to Ireland in the context of COVID-19, our Emergency Travel Advice Line number is +353 (0)1 613 1700.

Quarantine Requirements



- Introduced for all arrivals from 4 February 2021
- 14-day quarantine period must be undertaken at the address specified on the Passenger Locator Form
- You must quarantine for 14 days at the place of residence on your Passenger Locator Form. You can stop quarantining once you get a negative PCR test, taken no less than 5 days after arrival

Please note that hiring companies are still asking employees to self-quarantine for 14 days even if a PCR has been taken after arrival.



Persons who started their journey in South Africa or Brazil must complete the full 14 days of quarantine, regardless of whether a negative test result has been received.



Working in Ireland





A second
language is a
competitive
advantage

Market Situation

- At the height of the lockdown, around one fifth of the workforce could not work and a large share had still not resumed work in October
- Government's income support schemes is set to cushion the labour market shock
- Multilingual jobs are still on high demand in Ireland
- There has been a shift on the jobs in hospitality and tourism



NEW Trends and Opportunities



ENGINEERING AND SCIENCE

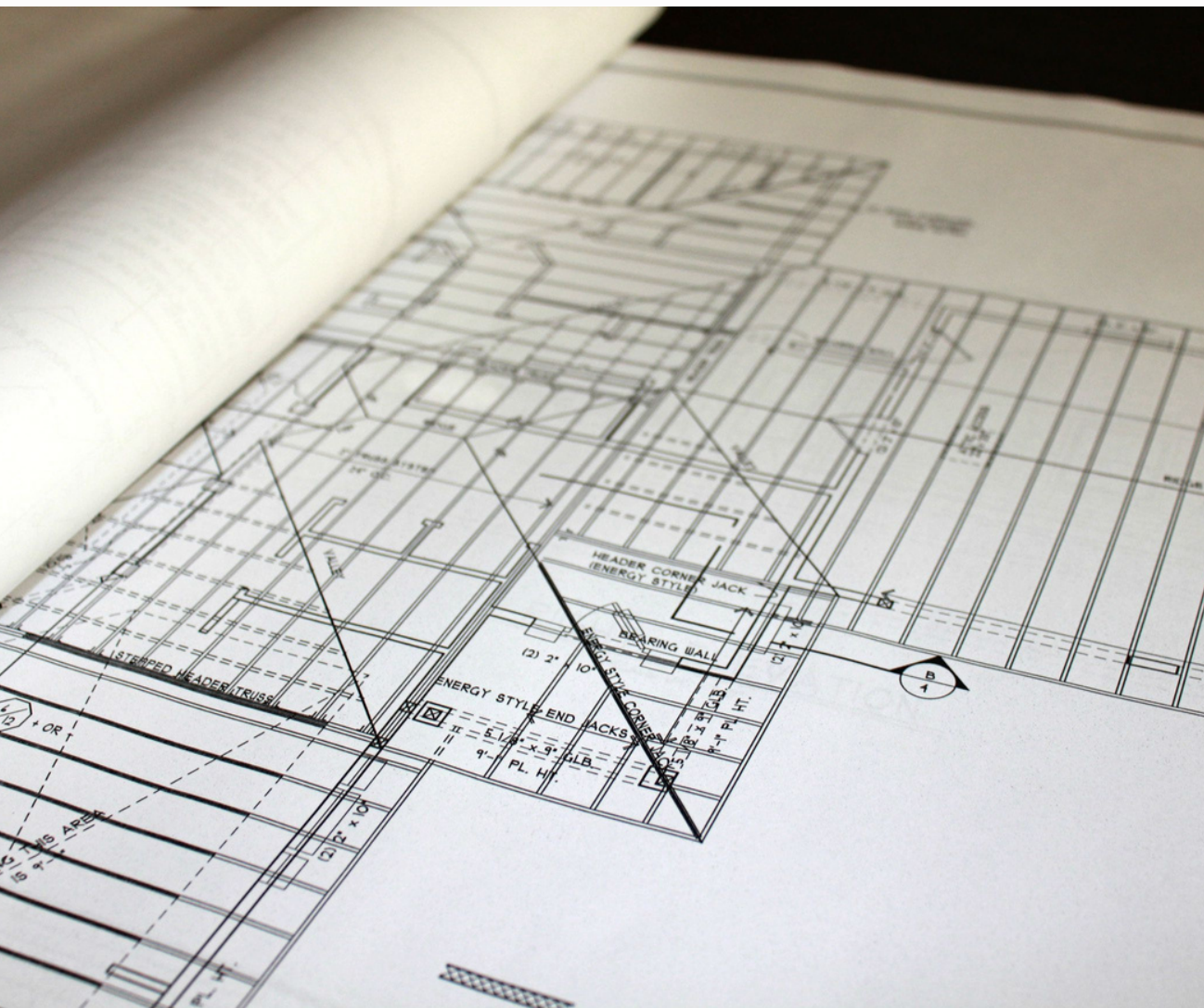

Engineering and Science



Biologics Processing and Testing

Experience with Immunoassay and Bioassay methods is highly sought after

Biopharmaceutics

Now almost all investment has been within Biopharmaceutics and there is certainly a shortage in talent

more companies are looking at attracting talent from overseas to bridge this gap

Clinical Trials

- Significant growth in the past 12 months
- There is a talent shortage in Ireland
- These hubs also have language requirements



EazyCity

Companies are very open to relocating talent and has a specific function to facilitate this move for their employees.

How do I apply?



FREE ASSESSMENT

with EazyCity



Apply directly on the links
provided



Internal employee referral.



Contact us!

Get a **customised and free**
consultation with one of our
advisors to go over your
experience, skills,
expectations....etc.



EazyCity



→ Job with a second language

Current work opportunities

Finance



Accounts Payable Specialist, Cork

Accounts Receivable Analyst, Cork

Accounts Payable Specialist, P2P
Analyst, Cork



Current work opportunities

Engineer & Science

Lab Analyst, Cork

Regulatory Associate CMC, Cork

Senior Quality, Regulatory &
Compliance Manager, Cork

Senior QA Manager, Dublin



Current work opportunities

Tech



Technical Support Representative
with German, Cork



Current work opportunities

Support & Service

Technical Support Advisor - German, Apple

IT Service Desk Associate - German Speaking

German Email Support - Work From Home Until Restrictions Are Lifted

Danish speaking Technical Support Analyst to global company in Ireland



EasyCity

Current work opportunities

HR

HR Services Support - German

Speaker for TE Connectivity.

Sales Recruiter (German Speaker)



EazyCity

Current work opportunities

Customer Service

CMS Analyst Nordics, Eli Lilly

Client Success Specialist,

Dedicated (German Speaker), Indeed

Account Executive - Norwegian Speaker

Account Manager, Nordics, Facebook



EazyCity

Current work opportunities

Sales

Warm Sales Specialist - Cork

Solutions Consulting Manager

Account Executive - North,

Salesforce

Dell Technologies Software Inside

Sales Central Northern Europe

Customer Base Corporate Sales

Development Representative -

Nordics



EasyCity

Closing Remarks



EazyCity



Remote and onsite work

Travel is not recommended as it yet. As a result, many companies are hiring to start working remotely and with the idea to join the company in the office later in the year (or as Covid-19 will allow).



The labour market in Ireland is still active

However, many other companies are still relocating people to Ireland at the moment. It is important to check on a job basis what are the conditions.



Information for travelling

For travelling to Ireland information, we highly recommend you to please visit the official Government's site for this purpose
<https://www.gov.ie/en/campaigns/75d92-covid-19-travel-advice/>



PCR

Please note as today 09/03/2021 it is necessary to be in the possession of a negative test when arriving to Ireland (ferry or plane) and quarantine for 2 weeks.



New trends in the labour market

High increase on demand for Engineering and Science roles in Ireland as they cannot be filled by local work force.

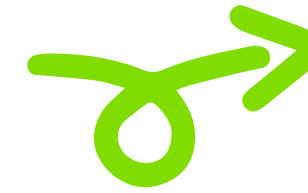

Shift in the market

There has been a switch in the market toward other sectors that recruit employees with a second European language such: sales, customer service, admin, IT, science and finance.



Jobs with languages

First time jobs abroad for non-native speakers in hospitality and tourism industries are now not available as result of Covid-19 and current restrictions.



Ask for an employee referral!

Connections are still key in the new virtual world.



EazyCity



Links

DFA - Department of Foreign Affairs

HSE - Health Service

Irish Government - Covid-19 website

Covid Tracker

PCR test clinic in Ireland



EazyCity

Q&A





We help you to start your experience abroad!

Job Plans



Job Seeker PRO in Cork

 Cork

 Job Seeker Pro

 125€

[Book Now](#)



Job Seeker PRO in Dublin

 Dublin

 Job Seeker Pro

 125€

[Book Now](#)

Accommodation in Ireland



<https://www.eazycity.net>

Copyright 2021. EazyCity Ltd