

# Work opportunities & travelling to Ireland

February 2021



EazyCity





# Key Talking Points

## What's on the agenda

- Current situation in Ireland
- Travelling to Ireland
- Information about what to do on entering Ireland from abroad
- Working in Ireland
- Market situation
- NEW trends and opportunities
- Current work opportunities
- Q&A



EazyCity



EazyCity



# Ciao!

**CRISTINA PICOCO,  
WORK ADVISOR AT EAZYCITY**

✉ [cristina@eazycity.com](mailto:cristina@eazycity.com)

☎ 0039 3802392078





## COUNTRY UNDER LEVEL 5 RESTRICTIONS

There is a Government Advisory in operation against all non-essential international travel



## EXTRA SHORT-TERM MEASURES ON INTERNATIONAL TRAVEL.

- Visa-free travel to Ireland for nationals of South Africa and all countries in South America has been suspended
- Temporarily ceased accepting new visa/preclearance applications globally (with limited exemptions)

## NATIONAL FRAMEWORK FOR LIVING WITH COVID-19

The plan sets out 5 levels that correspond to the severity of COVID-19 in a location. Different levels can be in place in different locations in the country.

Every county in Ireland is on alert Level 5 until 5 March 2021

# Current Situation in Ireland





# National Framework for living with COVID-19

More detailed information is available at [gov.ie/COVID19](https://www.gov.ie/COVID19)



	Very low rate of COVID-19 infections Low R-Number			Very high rate of COVID-19 infections High R-Number	
	Level 1	Level 2	Level 3	Level 4	Level 5
Social & Family Gatherings	Max: 10 from 3 other households	Max: 6 from 3 other households	Max: 6 from 1 other household	No visitors	No visitors
Weddings	Max: 100	Max: 50	Max: 25	Max: 6	Max: 6
Indoor Events	Depending on venue size 100 200	Depending on venue size 50 100	No organised events	No organised events	No organised events
Outdoor Events	Depending on venue size 200 500	Depending on venue size 100 200	Gatherings of up to 15	Gatherings of up to 15	
Sports Training	Normal training with protective measures	Indoors Pods of 6 Outdoors Pods of 15	1 Individual only Pods of 15 Non-contact	1 Individual only Pods of 15 Non-contact	Individual training only
Matches & Events	100 indoor 200 outdoor 500 stadia	50 indoor 100 outdoor 200 stadia	Except specific exemptions	Except specific exemptions	No events
Gyms, Pools & Leisure Centres	Open with protective measures	Open with protective measures	Individual training only	Closed	Closed
Religious Services	50 (or sub-groups of 50)	50 (or sub-groups of 50)	Services move online Funerals 25	Services move online Funerals 25	Services move online Funerals 10
Bars serving food, Cafés & Restaurants	Open with protective measures	Open Groups of 6 from up to 3 households	Range of restrictions up to and including no indoor dining	Outdoor dining only Max: 15 Takeaway/Delivery	Takeaway/Delivery only
Wet Pubs	Open with protective measures	Open Groups of 6 from up to 3 households	Range of restrictions up to and including no indoor service*	Outdoor only Max: 15 persons Takeaway/Delivery	Takeaway/Delivery only
Hotels, Guesthouses B&Bs	Open with protective measures	Open with protective measures	Services limited to Residents only	Existing Guests & Essential Purposes only	Essential Purposes only
Retail & Services	Mandatory face coverings Open with protective measures	Open with protective measures	Open with protective measures	Primarily outdoor Essential retail/services	Essential Retail only
Indoor Cultural Venues	Open with protective measures	Open with protective measures	Venues closed Libraries available for e-services/call & collect	Venues closed Online services available	Venues closed Online services available
Workplace	Work from home if possible Staggered attendance	Essential Meetings, Induction & Training only	Attend only if absolutely necessary	Essential & other designated workers only	Essential workers only
Domestic Travel	No restrictions	No restrictions	Stay in your county except for work, education & essential purposes	Stay in your county Except for essential work, education & essential purposes	Stay at home Exercise within 5km
Public Transport	Cycle or walk if possible Mandatory face coverings	50% Capacity Off-peak hours Peak hours prioritised to essential workers & purposes	50% Capacity Only when necessary	25% Capacity Avoid public transport	25% Capacity Avoid public transport
Schools & Childcare	Open with protective measures	Open with protective measures	Open with protective measures	Open with protective measures	Recommendations based on situation and evidence at time
Adult & Higher Education	Open with protective measures	Open with protective measures	Open Escalate all appropriate protective measures / limit congregation	Move online On-site attendance only when essential	Recommendations based on situation and evidence at time
Care Homes	Open with protective measures	Open with enhanced protective measures	Visiting suspended, aside from critical and compassionate circumstances		
Over 70s & Medically Vulnerable	Exercise judgement regarding engaging with others and in activities outside home.				

\*Pubs currently remain closed in Dublin



# National Framework Risk Level 5



## These are the restrictions for Level 5:

<b>Social &amp; Family Gatherings</b> home or garden  No visitors to home or garden <small>SEE NOTE 1 &amp; 2 BELOW</small>	<b>Indoor Sports Training</b>  None	<b>Religious Services</b>  Services online only	<b>Wet Pubs</b>  Takeaway & delivery only <small>*Remain closed to public</small>	<b>Workplace</b>  Work from home except essential	<b>Swimming Pools, Leisure Centres, Gyms</b>  Closed
<b>Weddings</b>  Max <b>25</b> With protective measures	<b>Outdoor Sports Training</b>  Individual only <small>SEE NOTE 3 BELOW</small>	<b>Funerals</b>  Up to <b>25</b> With protective measures	<b>Retail &amp; Personal Services</b>  Essential retail only <small>Mandatory face coverings</small>	<b>Travel – Out</b>  Stay at home Exercise within 5km	<b>Indoor Cultural Venues</b>  Closed
<b>Organised Indoor Events</b> (e.g. business/training/conferences/arts events)  None	<b>Matches &amp; Events</b>  None <small>SEE NOTE 4 BELOW</small>	<b>Bars, Cafes, Restaurants serving food</b>  Takeaway & delivery only	<b>Schools, Early Learning, &amp; Childcare Services</b> Open with protective measures	<b>Travel – In</b>  Stay at home Exercise within 5km	<b>Local Amenities</b>  Library services online only Playgrounds and parks open
<b>Organised Outdoor Events</b>  None	<b>Long-term Residential Care Facilities</b> Closed to visits except for critical or compassionate reasons	<b>Hotels, Guesthouses B&amp;Bs</b>  Essential stay only	<b>Adult/ Higher Education</b> Primarily online with exemptions for essential onsite activities	<b>Public Transport</b>  Essential public transport only, walk or cycle. <small>Mandatory face coverings</small>	<b>Over 70s &amp; Medically Vulnerable</b> Exercise judgement Stay at home as much as possible Limit social contacts

### NOTES

1. You may meet up outdoors with members of one other household but not at home.
2. An extended household or support bubble will be allowed in certain cases including for those at risk of social isolation.
3. Non-contact training for school aged children can continue in outdoor pods of 15.
4. Professional elite sports, intercounty matches, horse racing and greyhound racing may continue behind closed doors.

More information on [gov.ie/covid19](https://gov.ie/covid19)



Rialtas na hÉireann  
Government of Ireland



# Entering Ireland from abroad



## COMPLETE A COVID-19 PASSENGER LOCATOR FORM

- you must fill in a form before you arrive in Ireland called the COVID-19 Passenger Locator Form.
- Failure to do so is an offence.

## NEGATIVE TEST

- Required to have a negative / 'not detected' result from a pre-departure COVID-19 RT-PCR test.
- Before boarding their airplane or ferry.

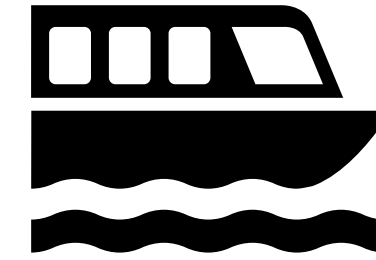

If you have queries regarding travel to Ireland in the context of COVID-19, our Emergency Travel Advice Line number is +353 (0)1 613 1700.



# Quarantine Requirements



- Introduced for all arrivals from 4 February 2021
- 14-day quarantine period must be undertaken at the address specified on the Passenger Locator Form
- You must quarantine for 14 days at the place of residence on your Passenger Locator Form. You can stop quarantining once you get a negative PCR test, taken no less than 5 days after arrival

Please note that hiring companies are still asking employees to self-quarantine for 14 days even if a PCR has been taken after arrival.



Persons who started their journey in South Africa or Brazil must complete the full 14 days of quarantine, regardless of whether a negative test result has been received.



# Working in Ireland







A second  
language is a  
competitive  
advantage



# Market Situation

- At the height of the lockdown, around one fifth of the workforce could not work and a large share had still not resumed work in October
- Government's income support schemes is set to cushion the labour market shock
- Multilingual jobs are still on high demand in Ireland
- There has been a shift on the jobs in hospitality and tourism





# NEW Trends and Opportunities

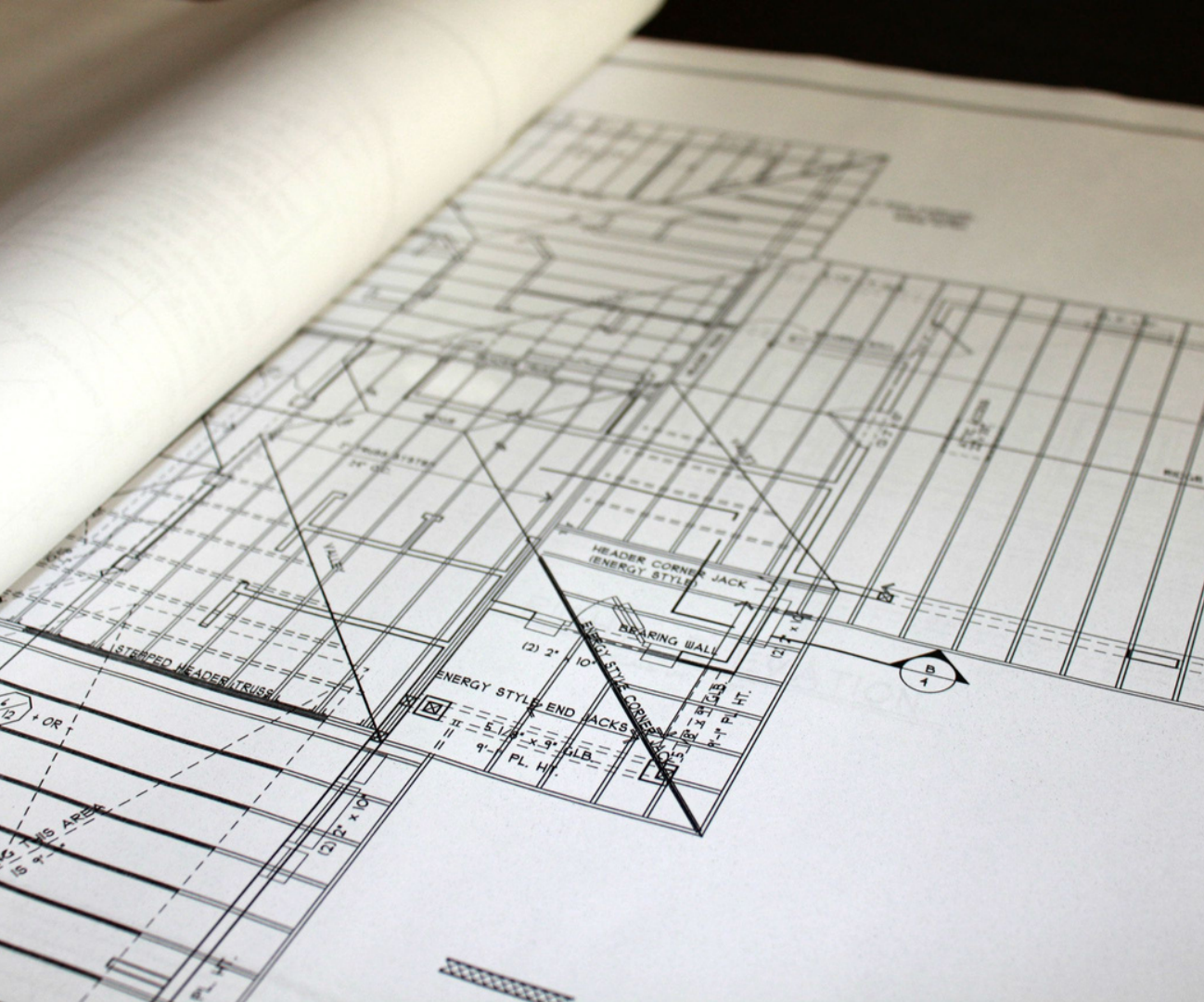

## ENGINEERING AND SCIENCE



EazyCity



# Engineering and Science



## Biologics Processing and Testing

Experience with Immunoassay and Bioassay methods is highly sought after

## Biopharmaceutics

Now almost all investment has been within Biopharmaceutics and there is certainly a shortage in talent

more companies are looking at attracting talent from overseas to bridge this gap

## Clinical Trials

- Significant growth in the past 12 months
- There is a talent shortage in Ireland
- These hubs also have language requirements



EazyCity

Companies are very open to relocating talent and has a specific function to facilitate this move for their employees.

# How do I apply?



**FREE ASSESSMENT**

with EazyCity



Apply directly on the links provided



Internal employee referral.

Contact us!

Get a **customised and free** consultation with one of our advisors to go over your experience, skills, expectations....etc.



EazyCity





**Job with a second language**



It is very common that the first job when travelling to Ireland is one related somehow with your native language.



# Current work opportunities

Finance

Accounts Payable Specialist, Cork

Accounts Receivable Analyst, Cork

Accounts Payable Specialist, P2P Analyst, Cork





# Current work opportunities

Engineer & Science

Lab Analyst, Cork

Regulatory Associate CMC, Cork

Senior Quality, Regulatory & Compliance Manager, Cork

Senior QA Manager, Dublin



# Current work opportunities

Tech



Technical Support Representative  
with German, Cork





# Current work opportunities

Administration

Agreement Admin Advisor - Italian

Speaking, Cork



EazyCity



# Current work opportunities

HR

eBay Italian Pro Trading Advisor,  
Dublin



EazyCity



# Current work opportunities

Customer Service

Airbnb Customer Support

Specialist - Italian Speakers

Airbnb Project - Customer Support

Specialist- Spanish- Cork

Airbnb Project - Customer Support

Specialist- Spanish- Cork

Fintech - Italian Customer Support

Specialist

Customer service with Italian,

Romanian & English



EazyCity



# Current work opportunities

Sales

Warm Sales Specialist - Cork

Selling Partner Support Associate -  
Italian & English

Inside Channel Account Manager -  
Italian Market

Marketing Cloud Account  
Executive - Italian Market



EazyCity



# Closing Remarks



EazyCity



## **Remote and onsite work**

Travel is not recommended as it yet. As a result, many companies are hiring to start working remotely and with the idea to join the company in the office later in the year (or as Covid-19 will allow).



## **The labour market in Ireland is still active**

However, many other companies are still relocating people to Ireland at the moment. It is important to check on a job basis what are the conditions.



## **Information for travelling**

For travelling to Ireland information, we highly recommend you to please visit the official Government's site for this purpose  
<https://www.gov.ie/en/campaigns/75d92-covid-19-travel-advice/>



## **PCR**

Please note as today 07/02/2021 it is necessary to be in the possession of a negative test when arriving to Ireland (ferry or plane) and quarantine for 2 weeks.



### **New trends in the labour market**

High increase on demand for Engineering and Science roles in Ireland as they cannot be filled by local work force.

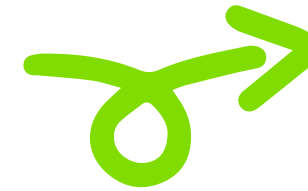

### **Shift in the market**

There has been a switch in the market toward other sectors that recruit employees with a second European language such: sales, customer service, admin, IT, science and finance.



### **Jobs with languages**

First time jobs abroad for non-native speakers in hospitality and tourism industries are now not available as result of Covid-19 and current restrictions.



### **Ask for an employee referral!**

Connections are still key in the new virtual world.



EazyCity





# Links

[DFA](#) - Department of Foreign Affairs

[HSE](#) - Health Service

[Irish Government - Covid-19 website](#)

[Covid Tracker](#)

[PCR test clinic in Ireland](#)



EazyCity



A grayscale photograph of a person from the chest up, holding a dark, textured rectangular board in front of their face. A large, white question mark is centered on the board. The person is wearing a dark t-shirt with some faint graphics. The background is a plain, light-colored wall.

**Q&A**



# We help you to start your experience abroad!

## Job Plans

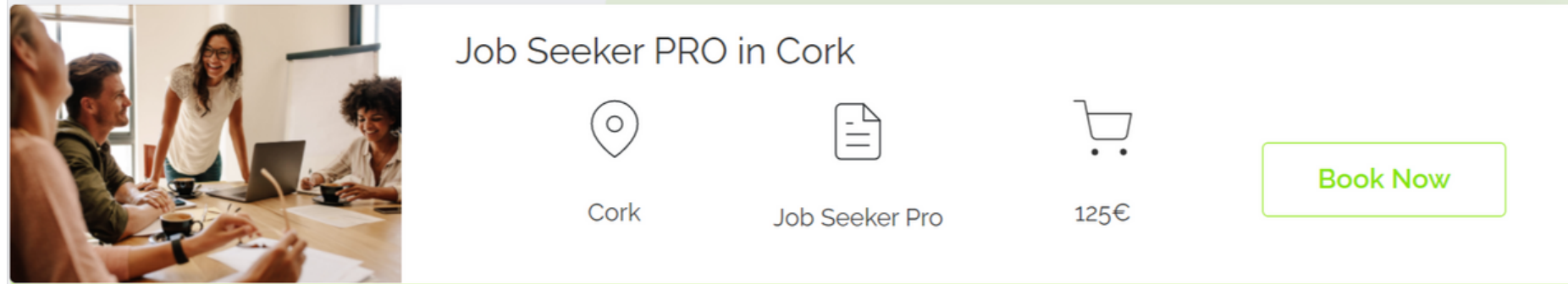

Job Seeker PRO in Cork

Cork Job Seeker Pro 125€ [Book Now](#)

This card features a small image of a meeting on the left. It displays the title 'Job Seeker PRO in Cork', a location pin icon for 'Cork', a document icon for 'Job Seeker Pro', a shopping cart icon for '125€', and a green 'Book Now' button.

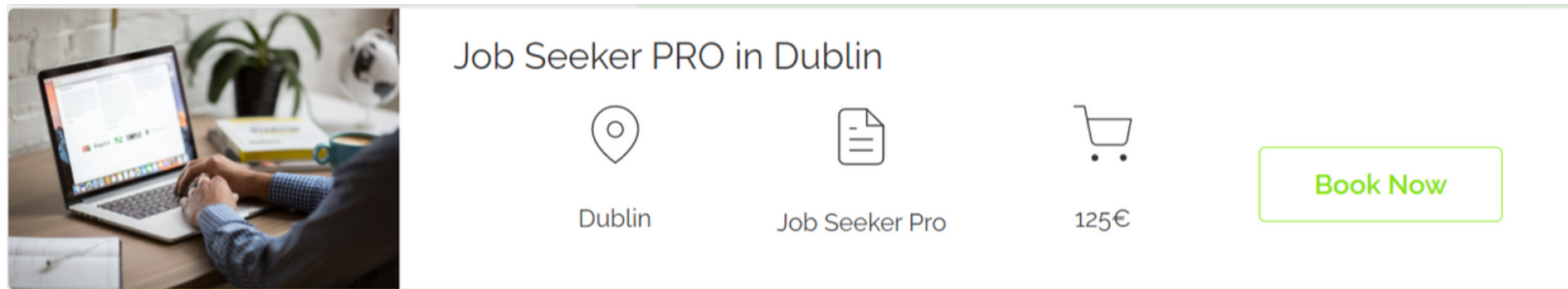

Job Seeker PRO in Dublin

Dublin Job Seeker Pro 125€ [Book Now](#)

This card features a small image of a person working on a laptop on the left. It displays the title 'Job Seeker PRO in Dublin', a location pin icon for 'Dublin', a document icon for 'Job Seeker Pro', a shopping cart icon for '125€', and a green 'Book Now' button.

## Accommodation in Ireland



<https://www.eazycity.net/it>

Copyright 2021. EazyCity Ltd